

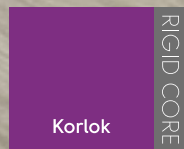

Karndean  
Designflooring

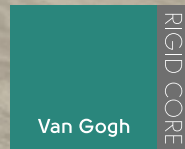

Korlok



Van Gogh



Knight Tile

# Karndean Rigid Core

Your **Design**flooring journey starts here





# Why Karndean?

At Karndean, we see flooring differently.

We travel the world in our quest to bring you exceptional floors that inspire and delight. From the ancient forests of Europe, to the remote Australian outback and beyond, we seek out expressive and intriguing forms in the natural world to influence our unique floor designs. By combining these original features with cutting edge design, we create simply beautiful floors that you'll love for a lifetime.

RKP8109 Reclaimed French Oak







# From *our* home

It all began in 1973 when a former flooring installer created a small family business from his family home.

With the belief that luxury vinyl flooring shouldn't just be practical, it needed to be beautiful as well, Karndean was formed. The team set out to travel the world, seeking inspiration from natural materials for what now are the most realistic luxury vinyl flooring products on the market.

The Karndean team worked out of that house for several years with the family's trusty dog, Smokey, the Great Dane who is still present on Karndean's logo today. For the family and Karndean's early employees — many who are still working with us today — these years bring back many fond memories.

Now stretching across the globe, beyond the walls of the original house, the Karndean family and employees continue to move forward with the same passion to deliver beautiful, innovative designs for your home.







# to *your* home

Designing your home can be overwhelming. There are many elements that must fit together, from furniture to flooring, to fixtures and everything in between. Where to begin?

We begin a new design with an inspiration, and we are most inspired by nature. What's your design motivation? Is it aesthetic, such as a throw pillow or the perfect paint chip? Or is it lifestyle, a place where you can dance in your pajamas and your babies (both two- and four-legged) can roll around and play?

No matter what drives you, Karndean was created with your needs in mind. We see flooring differently and by combining our original features with cutting edge design, you can create a simply beautiful floor that you will love for a lifetime.

Our simple method will help you navigate the selection process and design your perfect floor, taking you beyond picking a colour and measuring the room. Let's get started!



KARNDEAN REAL HOMES  
Meet Marcos and Lotta  
and find out their inspiration

Scan this QR Code or visit  
[karndean.com/marcosandlotta](https://karndean.com/marcosandlotta)







# How to use this book

From Print to Digital - design *your* floor, *your* way

RKP8108 Washed Butternut





## Mark it up

### YOUR DESIGN BLUEPRINT

This book is yours to sketch, doodle, draw and plan. Chock-full of content to help inspire your design journey, take full advantage and get creative.

## Try our digital tools

### GO MOBILE

Use our digital tools to help you choose your floor and visualize it in your space. Meet current Karndean customers and read their testimonials. Discover how Karndean will work for you.

## Take it offline

### VISIT US

The Karndean design team is ready to work with you. Visit [karndean.com](http://karndean.com) and enter your postal code to find your local retailer. Bring this book with you and let's put your dream floor renovation into action.

There is more to this book.  
Keep an eye out for QR Codes  
that link to tools, videos and more.

Scan me with  
your camera!

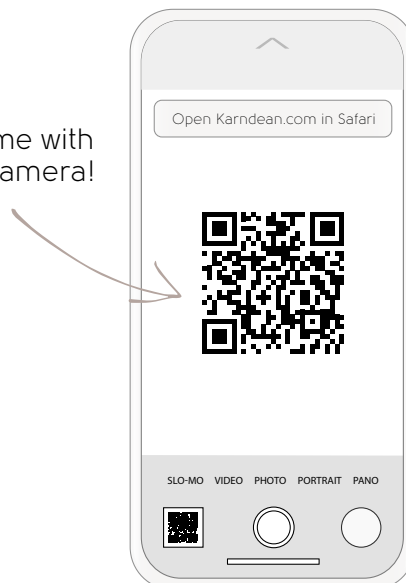



# *Your* Home, *Your* Design, *Your* Choice

## Browse our designs

Start online by filtering the designs you like by colour, size, format and more.

## Floorstyle

Upload a picture of your home and get creative. Explore your options by changing your laying pattern, picking your paint colours, and mixing designs.

## Bring it to life

Order a sample or visit your local retailer to see the product details and texture.



Floorstyle

Floorstyle allows you to design  
*your* space, *your* way

Start from  
*your* sofa



Scan this QR Code or visit  
[karndean.com/floorstyle](http://karndean.com/floorstyle)





## *Your* Town, *Your* Retailer, *Your* Choice

### Share your vision

Visit your retailer for recommendations on design, layout, transitions and more!

### Pick your colour

Look at the colour, texture and design to find the Karndean collection that works best for your home.

### See it in your home

Bring a sample home to see how the design will look in your space with your lighting, fixtures and colour scheme.

Visit *your*  
retailer



Scan this QR Code or visit  
[karndean.com/findaretailer](https://www.karndean.com/findaretailer)



# Visualize *your* space

Looking for inspiration but  
unsure where to start?

Try our interactive room viewer, Floorstyle, a revolutionary digital tool that provides not only room inspiration, but a realistic view of just how beautiful Karndean floors can look in your space.

Whether you're looking for wood or stone flooring, simply upload your own photo or choose one of our pre-set room images and immediately begin designing. Once you've decided on your favourite design, you can order samples, save your work, or print and share it with your retailer.

Try it today on your computer, tablet or mobile phone.

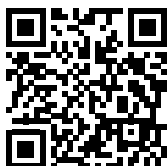

---

Scan this QR Code or visit  
[karndean.com/floorstyle](http://karndean.com/floorstyle)





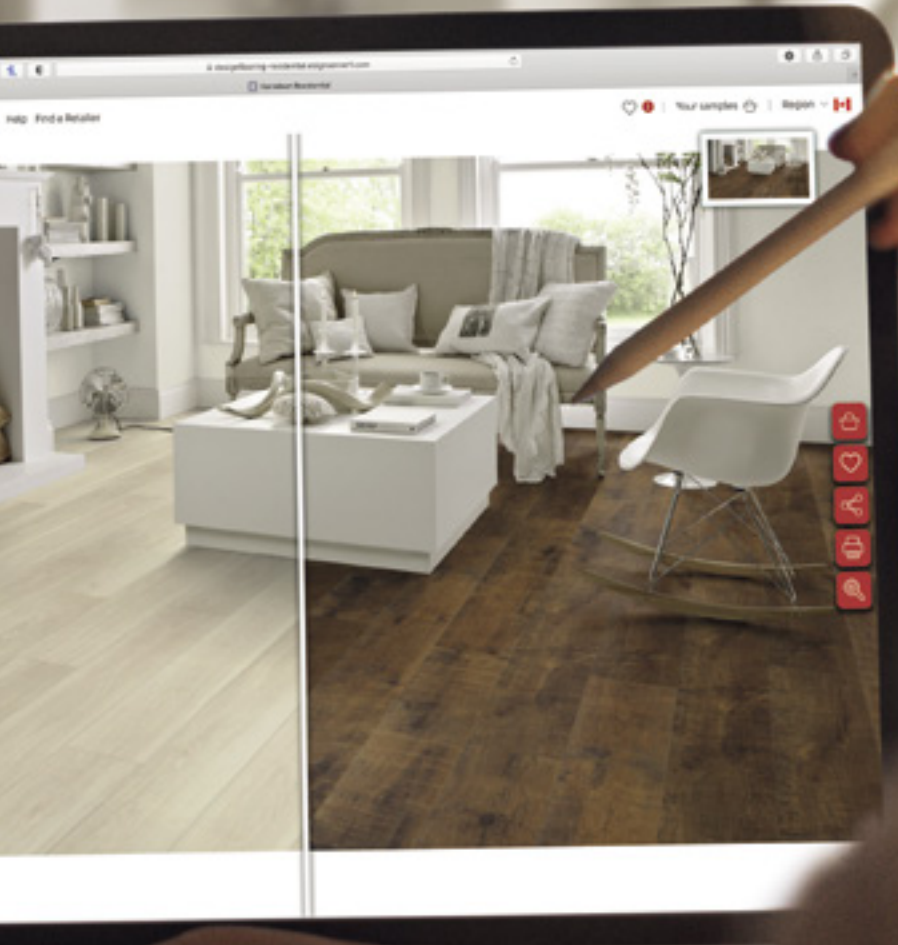



# Why Rigid Core?

Rigid core is a type of floating floor that clicks and locks into place, no adhesive necessary. It can be installed over most existing hard surfaces, meaning less upheaval in your home during installation.

An ideal alternative to laminate and engineered hardwood floors, rigid core offers the same realistic look, but with the durability and waterproof qualities of luxury vinyl.

RKP8215 Warm Brushed Oak



quick and easy  
to install

---

With a click-locking system that allows the installer to quickly drop and lock planks together.



installs over most  
existing hard floors

---

Rigid core products can be installed over most existing hard floor coverings.





## acoustic qualities

Reduces noise transfer to rooms below, making it perfect for upstairs bedrooms, playrooms or attic/loft conversions.



## no adhesive required

Due to its rigid core and click-locking mechanism, there is no need for adhesive when installing.

RKP8215 Warm Brushed Oak

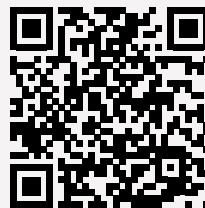

### OUR PRODUCTS Karndean Collections

This book is dedicated to our rigid core collections. Check out our other product offerings online or request a brochure.

Scan this QR Code or visit [karndean.com](http://karndean.com)





## family friendly

Karndean floors offer kids a safe and comfortable space to play, and parents a durable, easy-to-clean surface.

# Designed to **perform**

Dish it out. Our floors can take it.

RKT3010-G Sandstorm





LIFETIME WARRANTY



### pet friendly

From muddy paw prints, to household accidents, and anything in-between, Karndean floors are designed with pets in mind. Karndean's surface protection system works as a barrier against scuff marks and stains from our excitable furry friends.



### waterproof

The product's impervious vinyl backing helps ensure that no moisture gets through the floor.

RKP8105 Texas White Ash

LIFETIME WARRANTY



# Designed for **comfort**

Warm, soft and quiet.

SCB-KPI41 Urban Spotted Gum



quiet

Karndean flooring is quieter underfoot than natural wood and stone products. It will help to absorb sound and reduce the pitter-patter of paws and high heels across the floor.







## warm underfoot

---

Our products are warmer and softer underfoot than natural wood and stone flooring. For extra warmth, Karndean is easily used with underfloor heating systems.

RKP8109 **Reclaimed French Oak**



LIFETIME WARRANTY



## durable

All Karndean products carry a lifetime residential warranty. They won't splinter or crack, which means they will carry on performing no matter what life has to throw at them. With many accidents caused by trips and slips, Karndean also helps to avoid trip points and slippery surfaces with commercial grade slip ratings.

# Designed with you in **mind**

Practical flooring built to last.

RKP8116 Canadian Urban Oak







## environmentally friendly

---

Karndean is fully certified to Global GreenTag™ and our adhesives are free from harmful emissions. Ensuring the lowest impact on the environment, this certification means that all our products have been assessed and certified to comply with standards for low-omitting volatile organic compounds and indoor environmental air quality.



## low maintenance

---

Designed for a long, low-maintenance life. Our floors have no grime or dirt traps, unlike many of the materials it faithfully replicates.

RKP8107 **Smoked Butternut**



# Creating *your* perfect floor

It's not just the floor you choose  
but the direction you lay it that  
makes a lasting impression.



**Design your space**  
CHOOSE A LAYING PATTERN

SCB-ST17 Honed Oyster Slate



# Your Checklist

Choose your room

Bathroom \_\_\_\_\_

## Design your space

CHOOSE A LAYING PATTERN

- Diagonal
- Straight Lay Horizontal
- Straight Lay Vertical
- Brick Lay
- Striped 2-Colour

## Choose your look

WOOD OR STONE

- Wood
- Stone

## Pick your colour

CHOOSE YOUR DESIGN

- Light
- Mid
- Dark

SKU / Product Name

SCB-ST17  
Honed Oyster Slate

Collection Title

Knight Tile

Notes

Large bathroom with brick lay  
laying pattern



2

Choose your look  
WOOD OR STONE



3

Pick your colour  
CHOOSE YOUR DESIGN



# Design *your* space

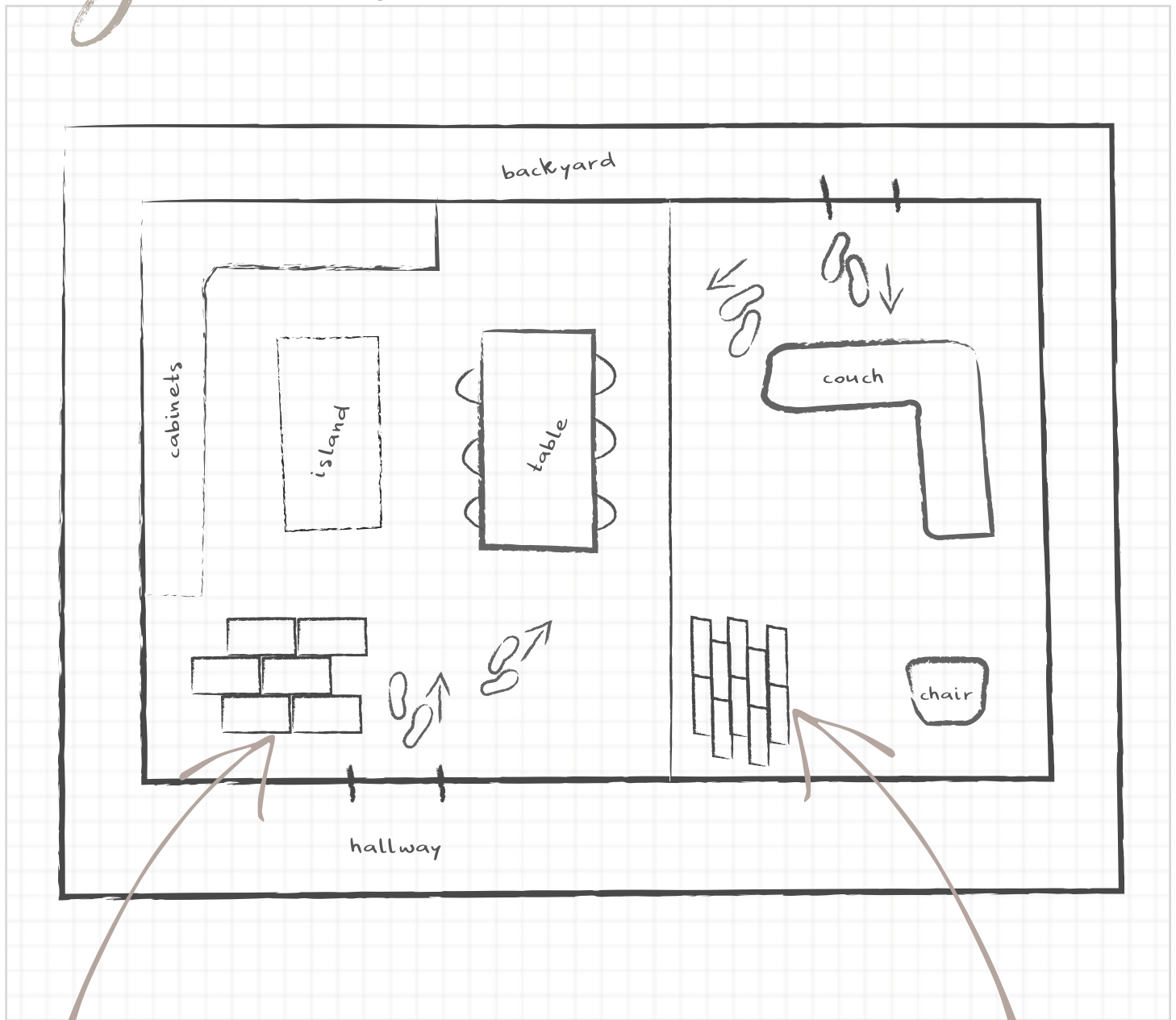

## **BRICK LAY STONE**

For this space we chose to lay the floor in a brick lay pattern. We chose this as we wanted a traditional look in the kitchen that would work for both directions of travel.

## **SEAMLESS TRANSITION**

We chose to combine a wood and stone look of the same thickness to create a seamless look throughout this open floor plan.

# Karndean Process

What's the shape of your space?

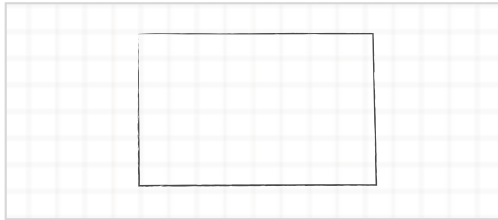

Where are the entry points?

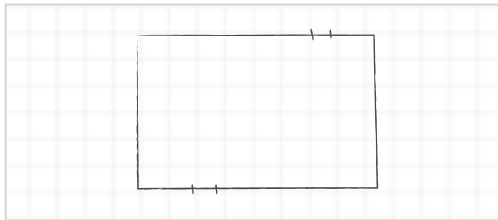

How do you enter the room?

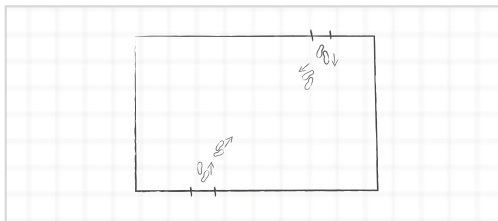

Are you updating rooms around it?

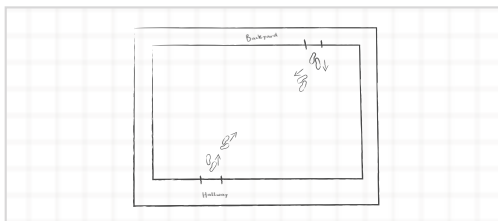

Is there any furniture that you're keeping in the renovation?

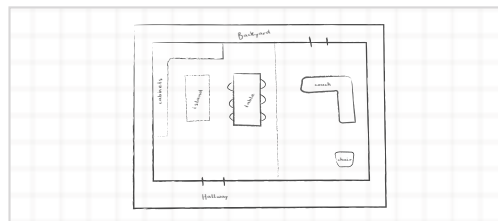

# Laying Patterns

Remember to ask yourself questions like: is it an open area? How will the flooring transition from one room to another? Should I use wood, stone or a combination? To pattern, or not to pattern?

## STONE TILES

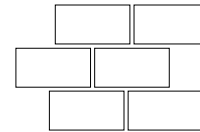

Brick Lay

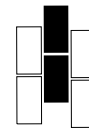

Striped 2-Colour

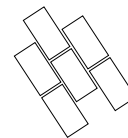

Diagonal

## WOOD PLANKS



Straight Lay

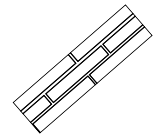

Diagonal



Striped 2-Colour



# Design *your* space

NOW IT'S YOUR TURN. JOT DOWN ANY INSPIRATION.

# Your Checklist

Choose your room

---

## Design your space

CHOOSE A LAYING PATTERN

- Diagonal
- Straight Lay Horizontal
- Straight Lay Vertical
- Brick Lay
- Striped 2-Colour

## Choose your look

WOOD OR STONE

- Wood
- Stone

## Pick your colour

CHOOSE YOUR DESIGN



Light



Mid



Dark

SKU / Product Name

---

---

Collection Title

---

Notes

---

---

## Get social with us

We want to know about your design journey and help you along the way



@karndean\_canada



Korlok

RIGID CORE

# Korlok stone in *your* home

RKT3013-G Brunella Marble



RKT3013-G  
**Brunella Marble**



SM-RKT3013-G  
**Brunella Marble**



## BEHIND THE DESIGN

# Brunella Marble

Calacatta marble has long been recognized around the world for its striking beauty, and was allegedly Michaelangelo's favourite stone to carve from. It originates from one single source: a mountainous area of Italy known as the Apuan Alps, making the original product both limited, and expensive.



Scan this QR Code or visit  
[karndean.com/korlok](https://karndean.com/korlok)

SM-RKT3013-G **Brunella Marble**





**Korlok**  
RIGID CORE

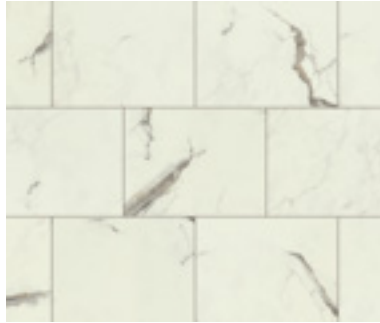

**Brunella Marble**  
RKT3013-G 18" x 24"



**Brunella Marble**  
SM-RKT3013-G 6" x 24"



**Baltic Limed Oak**  
RKP8111 56" x 9"



**Canadian Urban Oak**  
RKP8116 56" x 9"



**Warm Brushed Oak**  
RKP8215 56" x 9"



**Smoked Butternut**  
RKP8107 56" x 9"

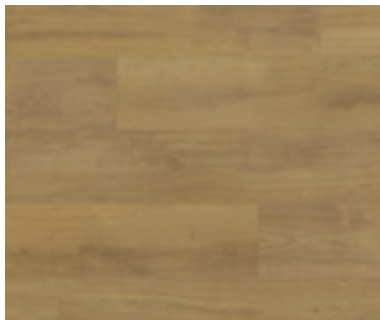

**Barley Oak**  
RKP8206 56" x 9"

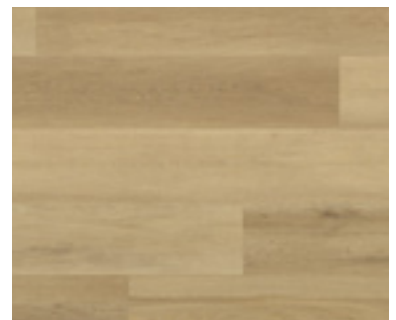

**Warm Ash**  
RKP8103 56" x 9"

**RKP8104 Washed Grey Ash**

This grey-tone plank offers a detailed design which will add impact to any space. Offering straight grain detailing and a lightly brushed appearance, this plank is a favourite among contemporary designers.

# Korlok in *your* home



**Ivory Brushed Oak**  
RKP8217 56" x 9"



**Arctic Mist**  
RKT3005-G 18" x 24"



**Metro Grey**  
RKT3007-G 18" x 24"



**Washed Butternut**  
RKP8108 56" x 9"

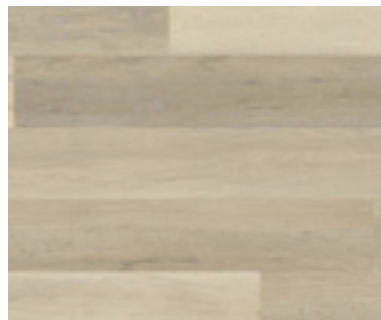

**Texas White Ash**  
RKP8105 56" x 9"



**Oyster Oak**  
RKP8202 56" x 9"



**Baltic Washed Oak**  
RKP8101 56" x 9"

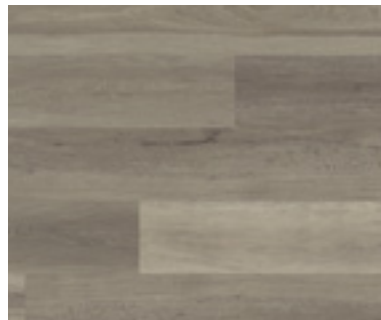

**Washed Grey Ash**  
RKP8104 56" x 9"



**Silver Barnwood**  
RKP8208 56" x 9"

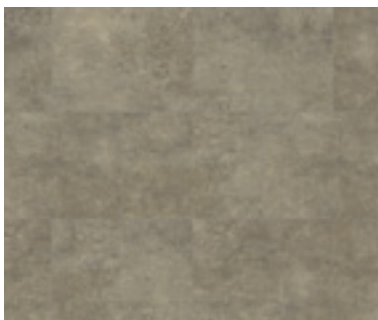

**Sandstorm**  
RKT3010-G 18" x 24"

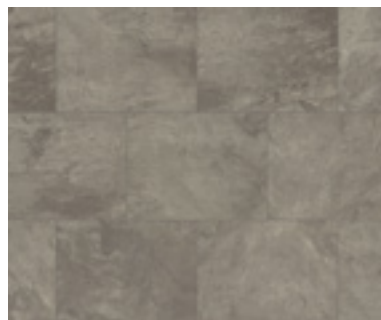

**Coastal Fog**  
RKT3004-G 18" x 24"

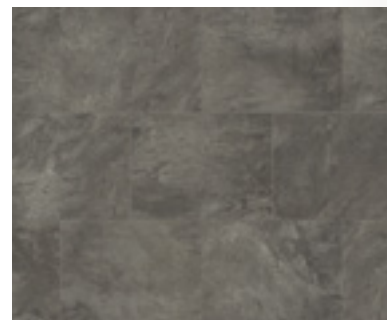

**Volcanic Slate**  
RKT3001-G 18" x 24"

LIGHT



MID



DARK







Korlok

RIGID CORE

---

#### RKT3008-G Oxford Grey

Oxford Grey is a lovely dove grey that will instantly add history to your home. This beautiful antique cotta design was developed from reclaimed French cotta, which is faded and more neutral in colour than the bold Spanish adobe cotta we often think of.

# Korlok in *your* home



**Reclaimed French Oak**

RKP8109

56" x 9"



**Oxford Grey**

RKT3008-G

18" x 24"



**Cathedral Oak**

RKP8114

56" x 9"



**Antique French Oak**

RKP8110

56" x 9"

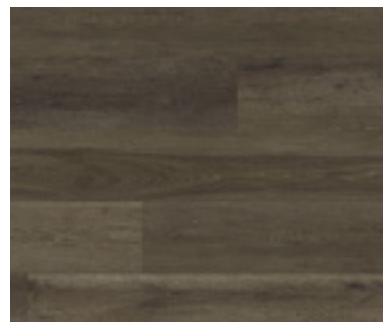

**Washed Velvet Ash**

RKP8102

56" x 9"

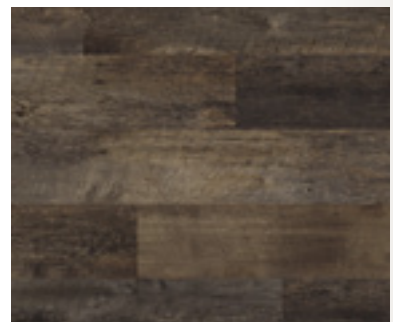

**Salvaged Barnwood**

RKP8209

56" x 9"

LIGHT



MID



DARK

## Check out our blog

Stay up to date on the latest flooring and design trends. Browse through design tips and tricks to help get you started on your next home project.

[karndean.com/ourblog](http://karndean.com/ourblog)





Van Gogh

RIGID CORE

Van Gogh  
in *your* home

SCB91 Tawny Oak





SCB91  
Tawny Oak

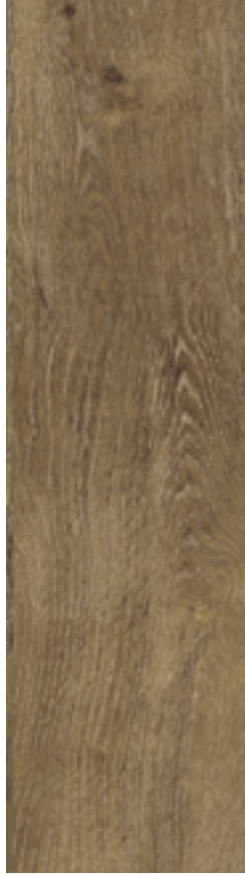

SCB93  
Hessian Oak



## BEHIND THE DESIGN

# French Oak

French Oak has been long-established as a popular choice for both flooring and wine-making, due to its high tannin content which adds flavour to wine and a slow-aged quality to floor boards. These designs embody a rich grain pattern and distinctive markings that will bring a new life to any space.



Scan this QR Code or visit  
[karndean.com/vangoghridcore](https://karndean.com/vangoghridcore)

SCB93 Hessian Oak





Van Gogh

RIGID CORE

---

### SCB81 Country Oak

Evoking a farmhouse feel, Country Oak has the rustic appearance of unfinished planks without the need for waxing or sanding. A cool mid-brown coupled with oak grain detailing, this floor complements vintage and contemporary interiors alike.

# Van Gogh in *your* home



**French Oak**

SCB85

48" x 7"



**Reclaimed Maple**

SCB71

48" x 7"



**Aged Redwood**

SCB100

48" x 7"

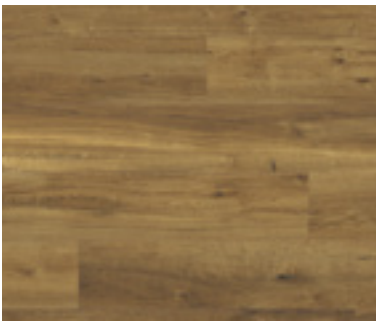

**Classic Oak**

SCB86

48" x 7"



**Hessian Oak**

SCB93

48" x 7"



**Country Oak**

SCB81

48" x 7"

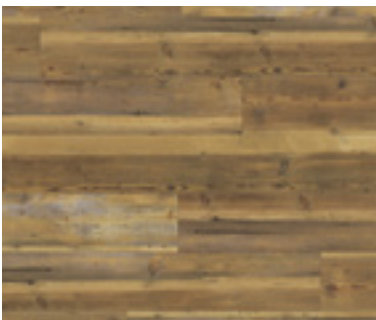

**Vintage Pine**

SCB76

48" x 7"

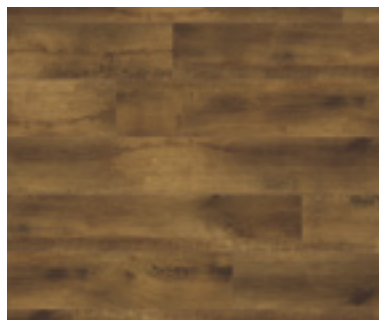

**Smoked Oak**

SCB70

48" x 7"



**Reclaimed Redwood**

SCB99

48" x 7"



**Tawny Oak**

SCB91

48" x 7"



Be *your* own  
designer with  
Floorstyle



Scan this QR Code or visit  
[karndean.com/floorstyle](http://karndean.com/floorstyle)

LIGHT



MID

DARK



Knight Tile

RIGID CORE

# Knight Tile in *your* home

SCB-ST16 Grey Riven Slate



SCB-ST16  
Grey Riven Slate

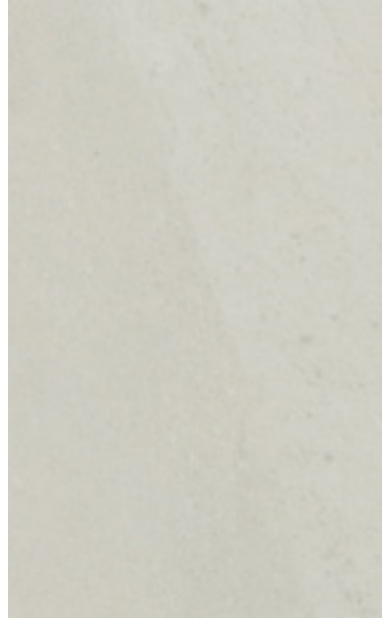

SCB-ST17  
Honed Oyster Slate



SCB-ST17 Honed Oyster Slate

## BEHIND THE DESIGN

# Slate

Sourced from quarries located in the heart of England's famous Lake District, these designs were created from formed volcanic rock dating back 300 million years. Only once a year, dynamite is used to extract slabs, which are then manually removed from the quarries. Two designs were created: one, a ground and polished design with an even finish; the other, exposing the natural split in the layers of the slate.



SCB-ST16 Grey Riven Slate



Scan this QR Code or visit  
[karndean.com/knighttilerigidcore](https://karndean.com/knighttilerigidcore)



A child's playroom featuring a wooden floor with a 'Lime Washed Oak' finish. The room includes a yellow window seat with colorful cushions, a table and chairs in blue and green, and various toys like a white dog-shaped stool and a toy cart. The wall is decorated with framed art and a window with a view of greenery.

Knight Tile

RIGID CORE

---

#### SCB-KP99 Lime Washed Oak

Lime Washed Oak planks look like worn, sun-bleached driftwood. With loads of variation in colour tones from plank to plank, this floor looks choppy than most when laid - perfect if you're going for a contemporary Scandinavian look.

# Knight Tile in *your* home



**White Painted Pine**  
SCB-KP105 48" x 7"

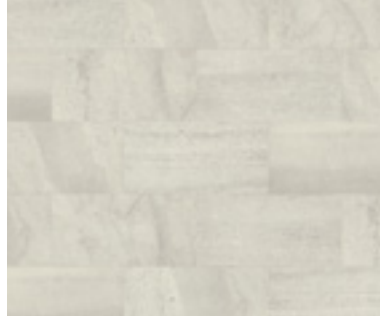

**Honed Oyster Slate**  
SCB-ST17 12" x 24"

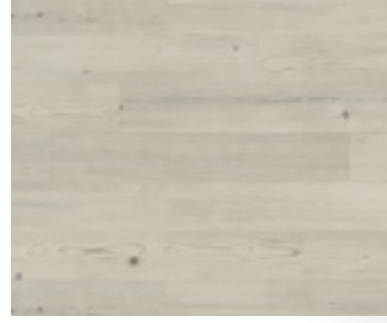

**Grey Scandi Pine**  
SCB-KP131 48" x 7"



**Pale Limed Oak**  
SCB-KP94 48" x 7"

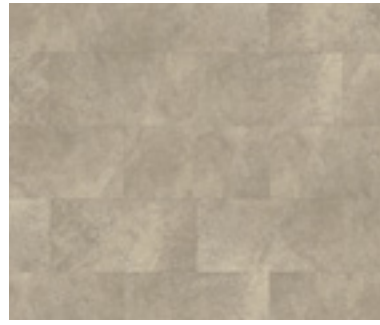

**Portland Stone**  
SCB-ST13 12" x 24"



**Grey Limed Oak**  
SCB-KP138 48" x 7"



**Mid Limed Oak**  
SCB-KP96 48" x 7"



**Lime Washed Oak**  
SCB-KP99 48" x 7"



**Grey Riven Slate**  
SCB-ST16 12" x 24"

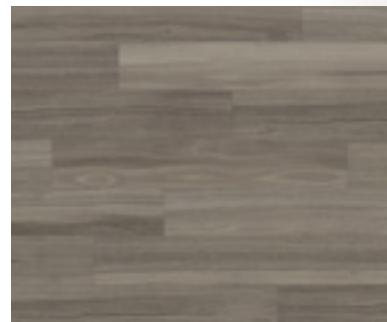

**Urban Spotted Gum**  
SCB-KP141 48" x 7"

LIGHT



MID

DARK

## Find your nearest recommended retailer

Use our online search feature to find your nearest retailer. Simply enter your postal code to see who is in your area.

[www.karndean.com/findaretailer](http://www.karndean.com/findaretailer)







Rigid core  
in *your* home

SCB-KP131 Grey Scandi Pine





# Formats Explained

## KARNDEAN RIGID CORE

Rigid core is a type of floating floor that clicks and locks into place, no adhesive necessary. Rigid core can be installed over most existing hard floors, meaning less upheaval in your home during installation. An ideal alternative to laminate and engineered hardwood floors, rigid core offers the same realistic look, but with the durability and waterproof qualities of luxury vinyl. This brochure is dedicated to our Rigid Core collections. For more design options browse our additional product formats below.

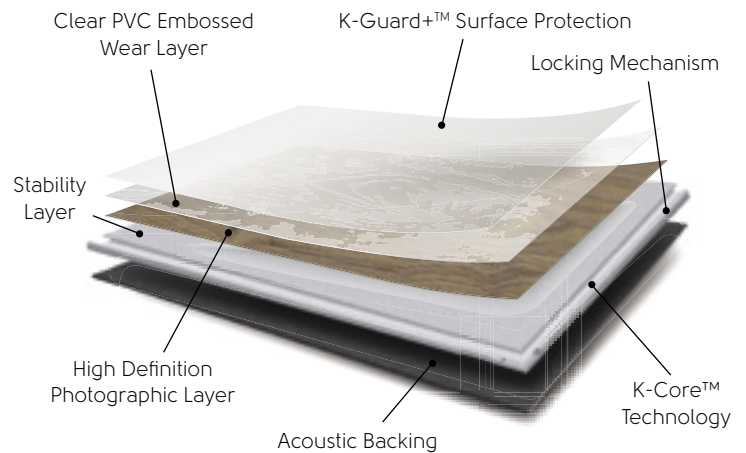

## KARNDEAN GLUEDOWN

Gluedown floors not only look authentic but allow for the most customization. From the distinctive texture of handscraped hickory to the intricate patterns of quarried stone, each floor mimics its natural counterpart. Gluedown floors can be installed in multiple laying patterns and be paired with design features that allow for personalisation, so your individual style can shine through. Learn more in our Gluedown Brochure.

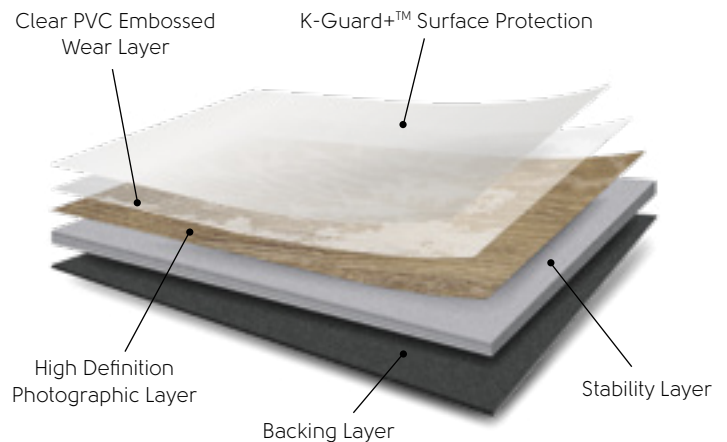

## KARNDEAN LOOSELAY

Featuring our K-Wave™ friction grip backing that holds the product in place, Karndean LooseLay creates a strong bond to the subfloor using a combination of weight and friction, with minimal adhesive. Perfect for temporary and permanent use, Karndean LooseLay is ideal if you are interested in changing out the floor frequently or a permanent floor that reduces noise transfer to rooms below. In addition, it's quick and easy to install and can be laid over most existing hard floors. Learn more in our Karndean LooseLay Brochure.

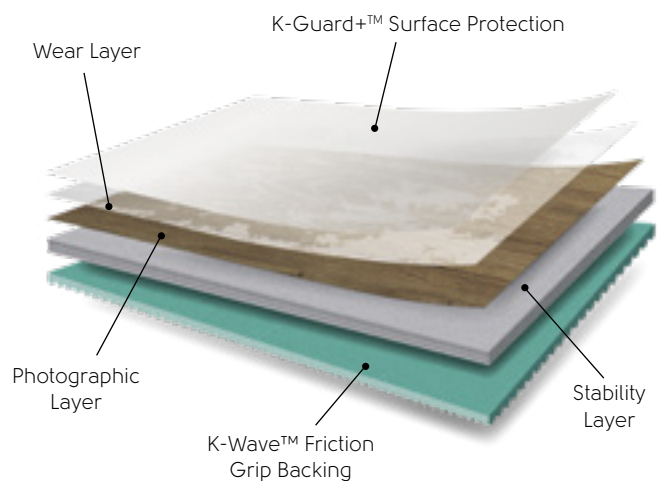

# Next Steps

## Find your nearest retailer

Shop local and get expert advice at our Karndean retailers. Simply enter your postal code on Karndean.com to find your local Karndean retailer.

[karndean.com/findaretailer](http://karndean.com/findaretailer)



## Order samples

Designed to help you pick which product is right for you. Order free 4" x 4" samples online right to your home.

[karndean.com/samples](http://karndean.com/samples)



## Request photography

Saw a swatch of a colour you like? Want to see what it looks like in a home? Simply email us the colours you like and we will send you photos of your favourite designs.

[info@karndeancanada.ca](mailto:info@karndeancanada.ca)



## Try our design tools

Become a designer yourself with our interactive digital tool Floorstyle. Upload a photo of your space then sort through designs, compare looks and play with laying patterns.

[karndean.com/floorstyle](http://karndean.com/floorstyle)



## Connect with us

We are constantly updating with new designs and innovations, so stay up to date by following us online. Share and connect with us through social media, so we can see your Karndean renovations.

   [@karndean\\_canada](https://www.instagram.com/karndean_canada)



### DISCLAIMER

Colour & Pattern Reproduction

All our products are inspired by things we have seen in nature. Just as variation in both colour and detail are part of the beauty of nature so too are some of our designs. This means that with some of our products you will see natural variation when your floor is laid.

We are continually developing new ideas and improving on our existing designs. This does mean that sometimes products are withdrawn on short notice.

Karndean Designflooring owns all its designs and are protected by copyright.

Contact us...

**Karndean Designflooring Canada**

**Call:** 866-819-6825

**Email:** [info@karndeancanada.ca](mailto:info@karndeancanada.ca)

\*Calls may be recorded for training and quality purposes.

Front cover: SCB-KP138 **Grey Lined Oak**

Back cover: RKP8110 **Antique French Oak**

3250 Harvester Road, Unit 3 Burlington, ON L7N 3W9



**Karndean**  
**Designflooring**

[www.karndean.com](http://www.karndean.com)





I think I found *my* home

**Karndean Designflooring Canadian Showroom**  
3250 Harvester Road, Unit 3 Burlington, ON L7N 3W9  
info@karndeancanada.ca  
1-866-819-6825



**Karndean**  
Designflooring